



AIA Document G710™ – 2017

Architect's Supplemental Instructions

PROJECT: *(name and address)*
16062 Gluckstadt Fire Station
Harbor Crossing on Yandell Road
near the Cedar Grove Lane
Intersection
Gluckstadt Mississippi

CONTRACT INFORMATION:
Contract For: General Construction
Date: May 01, 2017

ASI INFORMATION:
ASI Number: 001
Date: 16 May 2018

OWNER: *(name and address)*
Madison County, Mississippi
P.O. Box 608
Canton, MS 39046-0608

ARCHITECT: *(name and address)*
Dale Partners Architects P.A.(Jackson)
188 East Capitol Street
Suite 250
Jackson, Mississippi
39201

CONTRACTOR: *(name and address)*
Richard Womack Construction, LLC
P.O. Box 541
Magee, MS 39111

The Contractor shall carry out the Work in accordance with the following supplemental instructions without change in Contract Sum or Contract Time. Proceeding with the Work in accordance with these instructions indicates your acknowledgment that there will be no change in the Contract Sum or Contract Time.
(Insert a detailed description of the Architect's supplemental instructions and, if applicable, attach or reference specific exhibits.)

Please see attached directions for the donated Fire Place.

ISSUED BY THE ARCHITECT:

Dale Partners Architects P.A.(Jackson)

ARCHITECT *(Firm name)*

R. BLOUNT.
SIGNATURE

Russ Blount, AIA, Partner

PRINTED NAME AND TITLE

5/16/18
DATE



15 May 2018

T. Doug Dale, AIA
Jeffrey R. Barnes, AIA
Leigh G. Jaunsen, AIA, LEED AP
Russ S. Blount, AIA, LEED AP
Jason M. Agostinelli, AIA

In memory of
Michael A. Barranco, AIA
1962-2011

Danny Lee, Building and Grounds
Madison Board of Supervisors
125 West North Street
Canton, MS 39406

Re: 16062 Gluckstadt Fire Department 3 / Donated Fire Place

Dear Danny:

Please see attached sketch for the donated Fire Place at the new Gluckstadt Fire Station #3. We have review the current building conditions with the contractor and the donated unit will fit in the area beneath the flat screen TV in the Dayroom. This item and the associated installation was donated to the Fire District and will not impact the cost or schedule for the Fire Station. The contractor is aware of the changes and has provided the required gas connection to the fireplace location.

Sincerely,

A handwritten signature in blue ink that reads "D. Ford".

David Ford, AIA
Dale Partners Architects, P.A.

Enclosure

cc: Shelton Vance, Russ Blount, Richard Womack, Henry Davis

DALE PARTNERS ARCHITECTS, P.A.

Architecture • Interiors • Planning

One Jackson Place, Suite 250
188 East Capitol Street
Jackson, MS 39201-2100

P 601.352.5411 • F 601.352.5362

161 Lameuse Street, Suite 201
Biloxi, MS 39530

P 228.374.1409 • F 228.374.1414

dalepartners.com

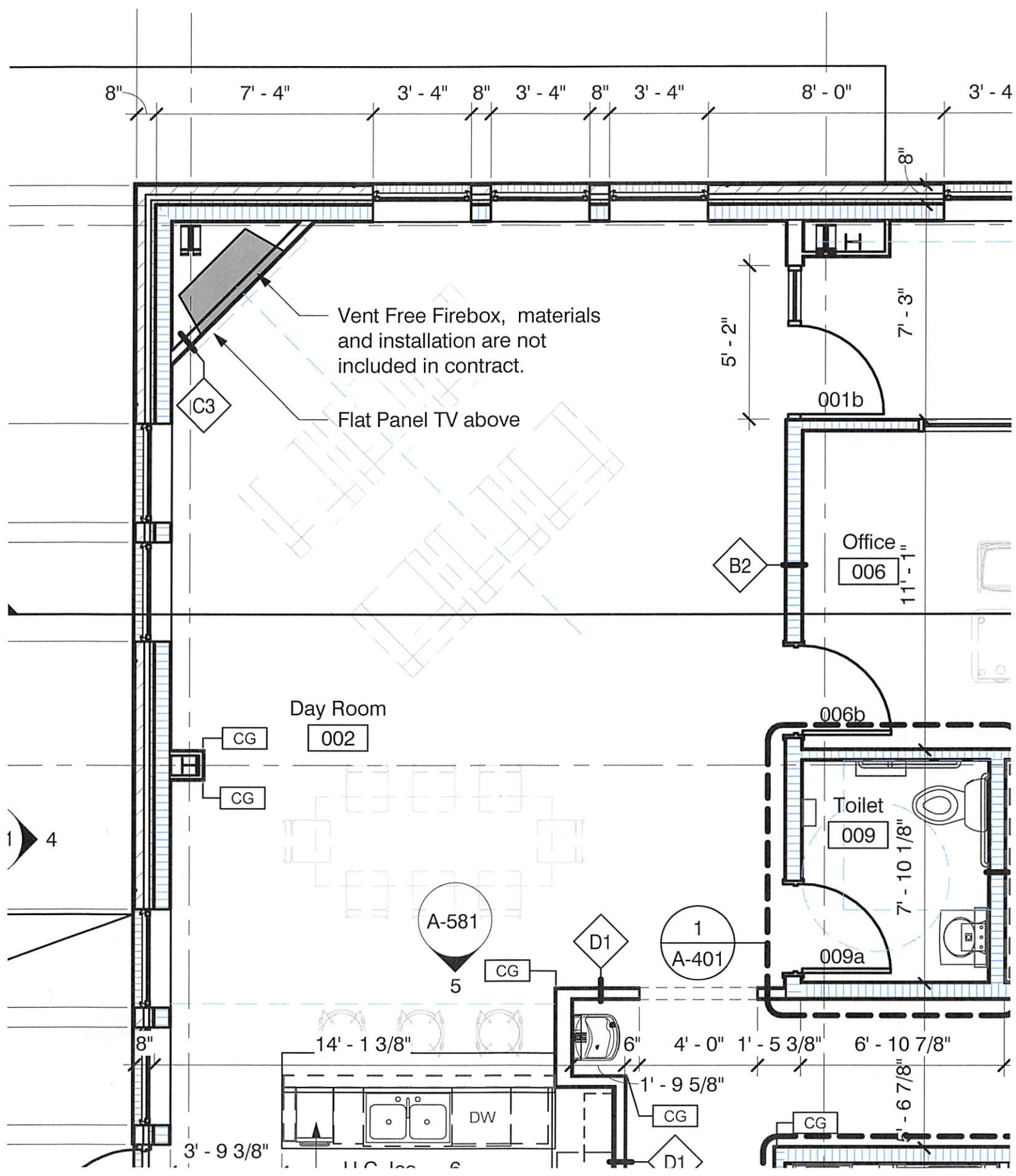

Gluckstadt Fire Station #3
 Location for Donated Fire Place
 Scale 1/4"=1'-0"
 May 15, 2018